

# 150LB 316 BSP SCREWED FITTINGS

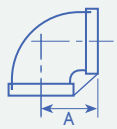

90° Elbow

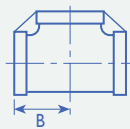

Equal Tee

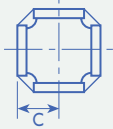

Equal Cross

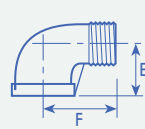

Street Elbow

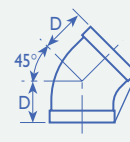

45° Elbow

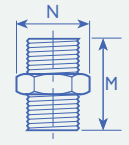

Hexagon Nipple

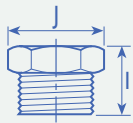

Hexagon Plug

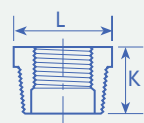

Reducing Bush

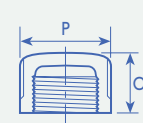

Round Cap

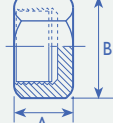

Hexagon Cap

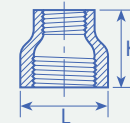

Reducing Socket

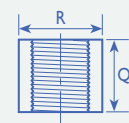

Full Socket



Hexagon Locknut

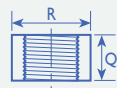

Half Socket

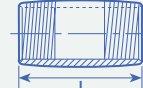

Barrel Nipple

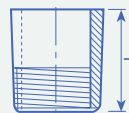

Weld Nipple

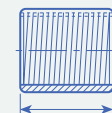

Parallel Nipple

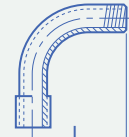

90° Male Bend

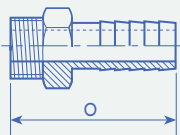

Hose Tail

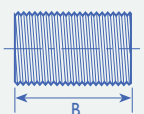

Close Taper Nipple

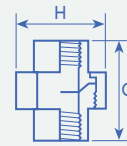

Union Fem  
/ Fem Conical

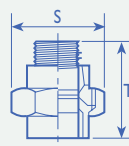

Union Male  
/ Fem Conical

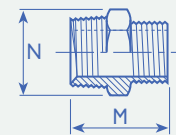

Reducing  
Hexagon Nipple

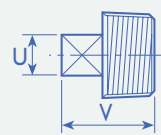

Square Head Plug

## Grade: 316 - One piece 1/4" - 2"

For chemical and industrial applications.  
Blow-out-proof stem design. 100% tested air under water, at 100psi open and closed positions.

### Specifications

- Working Pressure 800psi WOG
- Temperature range :  
-60 to 450°F
- End types:  
Threaded BSP
- Reduced Bore



## Grade: 316 - One piece 1/4" - 2"

For food and general chemical service applications.  
Blow-out-proof stem design. 100% tested air under water, at 100psi open and closed positions.  
Hydrostatic test pressure; 1500 p.s.i.

### Specifications

- Working Pressure 1000psi WOG
- Temperature range : -60 to 450°F
- End types: Threaded BSP
- Full Bore

# STAINLESS STEEL BALL VALVES

